

# TERRAIN DE CAMPING TOURISME - 2★

## CAMPING DE L'ETANG TITARD

Route de Louhans - 71330 ST GERMAIN DU BOIS

Tél : 03/85/72/06/15 (from 02/05 to 15/09)

@ : mairie@saintgermaindubois.fr

Tél : Town Hall (=mairie) : 03/85/72/01/47 (all year round)



The campsite 'Camping de l'Etang Titard' is located at the edges of the pond called 'Etang Titard' covering an area of 2 hectares in a wooded lot. You will appreciate the silence and enjoy the brightness of summer evenings at the water's edge and rediscover that life can be sweet. St. Germain is situated in the heart of the 'Bresse', between Burgundy and the Jura. On the local weekly market you will live an authentic experience. Many festive events are held, and in the local shops and businesses you will find everything you need during your holidays. You may stay fit by using our swimming pool (out and indoor), the different sport equipments and hiking circuits.

### PRICES/RATES : Mai 2 to September 15, 2024

#### DAILY RATE :

Adults (shower and warm water included)	2,70 €
Children (less than 10 years)	2,20 €
Vehicle	1,80 €
Emplacement	1,80 €
Camping car/van	3,80 €
Electricity	3,20 €
Pets	1.20 €
Chips for washing machine	5,80 €
Tourist tax (daily tax, for adults only)	0.20 €

#### MONTHLY RATE:

1 person	170,00 €
2 persons	240,00 €
3 persons	310,00 €
Additional Person	65,00 €
Pets (daily fee)	24 €
Double axle vehicles	PROHIBITED
Holiday vouchers	ACCEPTED

#### Plan d'accès

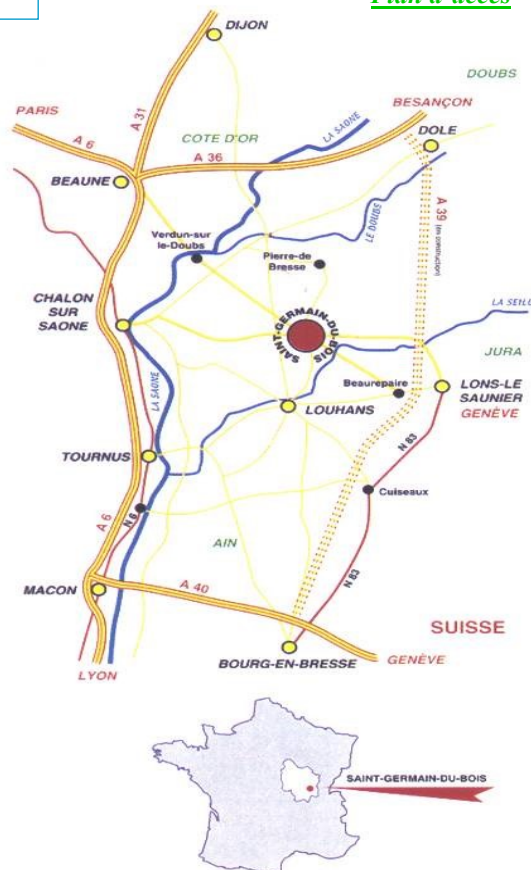

## LES CHALETS :

### HELIOS

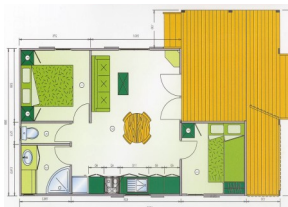

#### **1 wooden chalet - 5 persons - Total area 55,2 m<sup>2</sup>**

Indoor 34,90 m<sup>2</sup> + covered terrace 17,60 m<sup>2</sup>.

Including : 1 bedroom with 1 double bed (1.40m), 1 bedroom with 1 double bed (1.40)+ 1 bunk bed (0.70m). Fully equipped kitchen (sink, gas cooker, hood, dishwasher, fridge with ice cooler, oven, micro wave, coffee machine, Toaster, kettle), living with sofa and wooden coffee table/ dining area with pine table and extension, 5 chairs+2 stools/ bathroom with shower, ceramic basin, WC/ heating/ pillows and blankets (sheets not included, may be rented), TV en demand (can be rented)

### EDELWEISS



#### **1 wooden chalet - 5 persons - Total area 42,5 m<sup>2</sup>**

Indoor 35.00m<sup>2</sup> + covered terrace 7.50m<sup>2</sup> (access for disabled person)

Including : 1 bedroom with 1 double bed (1.40m), 1 bedroom with 1 double bed (1.40)+ 1 bunk bed (0.70m). Fully equipped kitchen (sink, gas cooker, hood, fridge with ice cooler, oven, micro wave, coffee machine, Toaster, kettle), living with sofa / dining area / bathroom with shower, WC/ heating/ pillows and blankets (sheets not included, may be rented) TV en demand (can be rented)

### GOELAND



#### **3 wooden chalets - 5 persons - Total area 45 m<sup>2</sup>**

Indoor 35.00m<sup>2</sup> + covered terrace 7.50m<sup>2</sup>

Including : 1 bedroom with 1 double bed (1.40m), 1 bedroom with 1 double bed (1.40)+ 1 bunk bed (0.70m). Fully equipped kitchen (sink, gas cooker, hood, fridge with ice cooler, oven, micro wave, coffee machine, Toaster, kettle), living with sofa and wooden coffee table/ dining area with pine table and extension, 5 chairs+2 stools/ bathroom with shower, ceramic basin, WC/ heating/ pillows and blankets (sheets not included, may be rented) TV en demand (can be rented)

### Tariffs for the accommodation in Chalets

**\* During the high season, rentals are available for 2 nights minimum, according to their availability**

TYPE of CHALETS	HIGH SEASON JULY/AUGUST					THE REST OF THE YEAR - SEPTEMBER TO JUNE							
	2 nights	1 week	2 weeks	3 weeks	1 month	2 nights	3 nights	4 nights	5 nights	1 week	2 weeks	3 weeks	1 month
HELIOS	140	450	680	900	1150	105	160	210	262	367	555	700	900
GOELAND	130	430	640	860	1080	95	140	190	235	330	480	630	790
*EDELWEISS	130	430	640	860	1080	95	140	190	235	330	480	630	790

\* Access for disabled person

## Free facilities and activities :

Once you rent a pitch or an accommodation, several facilities and activities are free, such as

- Petanque court
- Ping-pong tables (remember to bring your rackets)
- Skate park
- Children's playground, under the responsibility of the parents
- Access to the TV room - entertainment
- Tourist information

## Chargeable services : Season 2023

- Entry to the swimming pool
- Tennis : rental of tennis court
- Washing machine : chips (available at the office) – 5.80 €
- Library
- Sheet rental : 6 € per bed (for HLL)
- Barbecue day : 5.00 €
- Weekly barbecue : 20.00 €
- Barbecue deposit : 90.00 €

## Inventory of the chalets equipments :

6 stackable water glasses	1 stainless steel dish
6 wine glasses	1 plate for oven
6 glasses for lemonade	2 saucepans/ cooking pots
1 water pot (glass)	2 frying pans
1 stainless steel pot	1 tin- opener
8 forks	1 bottle- opener
8 knives	1 vegetable peeler
8 spoons for soup	1 cheese grater
8 tea spoons	1 beaker
8 steakknives	1 bell for Micro wave ovens
12 flat plates	1 gas lighter
12 soup plates	1 trivet
12 dessert plates	1 coffee machin
6 bowls (mugs)	1 toaster
6 tea cups	1 mini oven
2 Salad servers	6 hangers
1 Bread basket	1 trash can in kitchen
1 Basket for cutlery	1 trash can in bathroom
1 Breadboard	1 washtub
3 airtight bowls	1 sponge
1 butter dish	1 floor cloth with fringes
1 ladle (black)	1 broom
1 big spoon (black)	1 small broom and dustpan
1 server(black)	1 seal + accessories
1 strainer/ sieve	1 closet brush and accessories
1 salad spinner	1 garden Lounge
1 large stewpot	1 laundry dryer
1 large bowl (glass)	5 pillows
1 vegetable dish (stainless steel)	3 duvets
1 plate (stainless steel)	3 blankets

## Terms and Conditions :

### **Art. 1: Period of stay:**

The customer signing this contract concludes for a fixed term and he is not allowed to stay longer. He must occupy himself the Chalet and mustn't rent it to others.

### **Art.2 : Conclusion of the contract :**

The booking becomes valid, once the Town hall (Mairie) of St. Germain du Bois received the deposit of 25 % of the total price, one signed and dated exemplary of the booking form as well as an IBAN and Swift, before the mentioned date. The 2<sup>nd</sup> copy should be kept by the customer.

### **Art. 3 : Cancelling by the customer :**

**A) Cancellations** must be notified by 'registered letter' sent to the Town hall (mairie).

- Cancellation 30 days before the beginning of the stay/ arrival day:

the owner (mairie) will keep 25% (that means the deposit)

- Cancellation less than 30 days before the arrival day:

the 100% will be kept by the owner (mairie) , except in cases of force majeure

#### **B) No- Show :**

If the customer does not show up in between the 24 hours following his arrival date, the present contract is no more valid. The owner may freely dispose of his Chalet. He will keep 100% of the rental cost.

#### **C) Shortened stay :**

In case of shortened stay, you have to pay the price corresponding to the total length of the stay, the amount belongs to the owner.

### **Art. 4 : Cancelling by the owner :**

When the owner has to cancel the stay before the arrival day, he must inform the customer by registered letter (with acknowledgment of receipt). The customer will be (without any legal procedure) reimbursed for his payments and will receive a compensation for the damages caused by the cancellation. (the allowance will be same amount as the penalty he would have had to pay if it was the customer who had cancelled).

### **Art. 5: Pets :**

**PETS ARE PROHIBITED IN THE CHALETS – NO PETS IN THE CHALETS !!!**

### **Art. 6: Arrival and departure :**

The customer has to arrive the day and during the hours notified on the booking form. If you are late, please phone to the owner/ responsible.

**High season : arrival times on Saturday between 15h30 and 18 h, departure on Saturday between 9h30 and 10 h.**

**Between September and June :**

**Arrivals : from Monday to Saturday : 14h00 - 16h00 pm**

**Departure : Monday to Saturday : 9h00 - 11h00**

**On Sunday : arrival and departure : between 9h and 10 h**

### **Art. 7: Settlement**

The balance has to be paid 1 month before the arrival date (to be sent to the Mairie de St. Germain du Bois).

### **Art. 8: Deposit:**

At your arrival you will be asked for a deposit of 300.-€ covering any possible damage (2 checks) - (200.-€ for damage in the Chalet, broken dishes etc and 100.-€ if you don't do the cleaning before leaving). This deposit will be refunded 8 days after your departure, the price of possible damages deducted. In case the deposit does not cover the damages, you will receive an invoice to be settled to the 'Trésor Public'.

### **Art. 9 : Using the campsite**

All customers have to respect the present terms and conditions and ensure the peaceful character of the campsite.

### **Art. 10: Accommodation capacity:**

The number of expected persons is notified on the booking form. If, however the number of persons arriving exceeds the accommodation capacity of the chalet, the owner may refuse the access to the accommodation. This refusal cannot be considered as a modification or breach of contract since the number of holidaymakers is no more according to the signed booking form. If the customers leave, they will not be reimbursed.

### **Art. 11:- Insurance**

The customer is responsible for all damage caused by him. He is strongly advised to buy an insurance covering these risks.

### **Art. 12: Insurance**

**NO SMOKING IN THE CHALETS!!!!!!**

## BOOKING FORM

To be valid, this form has to be sent back to the town hall (mairie)

MAIRIE - 71330 St GERMAIN DU BOIS

Tél : 03-85-72-01-47

Family name : ..... Number of persons : .....  
First name : ..... Adults (over 18): .....  
Postcode : ..... Domicile : ..... Children : .....  
Adress : ..... Nationality : .....  
.....  
Date and place of birth : ..... E-mail : .....  
Tél : ..... Fax : .....  
Profession : .....

Booking from : ..... until .....

### Accommodation in chalet :

Chalet « Hélios » 5 persons - 35 m<sup>2</sup> n° .....  
 Chalet « Goéland » 5 persons - 35 m<sup>2</sup> n° .....  
 Chalet « Edelweiss » 5 persons (access for disabled person) - 35 m<sup>2</sup> n° 5

Bed sheets hire : 6 € x ..... = .....  Optional cleaning charge: € 100.00

**Tourist tax:** Number of nights : ..... x 0.20 € = ..... X .....persons adults= .....

Rental : .....+ Tourist tax .....+ Bed sheets .....+ cleaning charge .....€ = .....

25 % deposit : .....€ (to be sent with your booking form)

**At your arrival you will be asked for a deposit of 300.-€ covering any possible damage (200.-€ for damage in the Chalet, broken dishes etc and 100.-€ if you don't do the cleaning before leaving).** This deposit will be refunded 8 days after your departure .

### Payment :

: by check (at the order of 'Trésor Public')  
 : by holiday voucher  
 : by bank transfer (IBAN : FR76 1007 1710 0000 0020 0289 016 BIC : TRPUFRP1) TRESOR PUBLIC  
 : cash

This booking is valid, once we received at our address and before the date of.....:

☞ One exemplary of this booking form, dated and signed by the customer (you keep the second copy)

☞ The deposit .....€ (25% of the total cost)

The balance of .....€ has to be settled 1 month preceding the date of your arrival.

By my signature, I hereby declare to agree with the terms of this contract. I read the description and conditions and terms.

St Germain du Bois .....

Signature of the chalet's owner

Date and place.....

(preceded by the formula "read and approved")

Signature of the Tenant :

**At your arrival, Mme Corinne Roy will welcome you (Tel: 06 79 28 81 96), please call one week before you arrival.**